



Hilti HIT-RE 500-SD mortar with rebar (as anchor)

Injection mortar system	Benefits
 <p>Hilti HIT-RE 500-SD 330 ml foil pack (also available as 500 ml and 1400 ml foil pack)</p> <p>Statik mixer</p>  <p>rebar BSt 500 S</p>	<ul style="list-style-type: none"> - SAFEset technology: drilling and borehole cleaning in one step with Hilti hollow drill bit - suitable for non-cracked and cracked concrete C 20/25 to C 50/60 - ETA seismic approval C1 - high loading capacity - suitable for dry and water saturated concrete - large diameter applications - high corrosion resistant - long working time at elevated temperatures - odourless epoxy - embedment depth range: from 60 ... 160 mm for Ø8 to 128 ... 640 mm for Ø32



Concrete



Tensile zone



Seismic
ETA-C1



Small edge distance and spacing

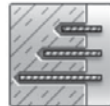

Variable embedment depth



Fire resistance

SAFEset

Hilti SAFEset technology with hollow drill bit



European Technical Approval



CE conformity



PROFIS Anchor design software

Approvals / certificates

Description	Authority / Laboratory	No. / date of issue
European technical approval ^{a)}	DIBt, Berlin	ETA-07/0260 / 2013-06-26
ES report incl. seismic	ICC evaluation service	ESR 2322 / 2014-02-01
Fire test report	MFPA, Leipzig	GS-III/B-07-070 / 2008-01-18
Assessment report (fire)	warringtonfire	WF 327804/B / 2013-07-10

a) All data given in this section according ETA-07/0260, issue 2013-06-26.

Basic loading data (for a single anchor)

All data in this section applies to

For details see Simplified design method

- Correct setting (See setting instruction)
- No edge distance and spacing influence
- *Steel* failure
- Base material thickness, as specified in the table
- One typical embedment depth, as specified in the table
- One anchor material, as specified in the tables
- Concrete C 20/25, $f_{ck,cube} = 25 \text{ N/mm}^2$
- Temperature range I
(min. base material temperature -40°C , max. long term/short term base material temperature: $+24^\circ\text{C}/40^\circ\text{C}$)
- Installation temperature range $+5^\circ\text{C}$ to $+40^\circ\text{C}$

Embedment depth ^{a)} and base material thickness for the basic loading data.

Mean ultimate resistance, characteristic resistance, design resistance, recommended loads.

	Data according ETA-07/0260, issue 2013-06-26								
Anchor size	Ø8	Ø10	Ø12	Ø14	Ø16	Ø20	Ø25	Ø28	Ø32
Typical embedment depth [mm]	80	90	110	125	125	170	210	270	300
Base material thickness [mm]	110	120	145	165	165	220	275	340	380

a) The allowed range of embedment depth is shown in the setting details. The corresponding load values can be calculated according to the simplified design method.

Mean ultimate resistance: concrete C 20/25 – $f_{ck,cube} = 25 \text{ N/mm}^2$, anchor rebar BSt 500S

	Data according ETA-07/0260, issue 2013-06-26									
Anchor size	Ø8	Ø10	Ø12	Ø14	Ø16	Ø20	Ø25	Ø28	Ø32	
Non cracked concrete										
Tensile $N_{Ru,m}$ BSt 500 S [kN]	29,4	45,2	65,1	89,3	94,1	149,2	204,9	298,7	349,9	
Shear $V_{Ru,m}$ BSt 500 S [kN]	14,7	23,1	32,6	44,1	57,8	90,3	141,8	177,5	232,1	
Cracked concrete										
Tensile $N_{Ru,m}$ BSt 500 S [kN]	23,8	33,5	46,1	57,0	65,2	110,8	146,1	228,7	268,1	
Shear $V_{Ru,m}$ BSt 500 S [kN]	14,7	23,1	32,6	44,1	57,8	90,3	141,8	177,5	232,1	

Characteristic resistance: concrete C 20/25 – $f_{ck,cube} = 25 \text{ N/mm}^2$, anchor rebar BSt 500 S

	Data according ETA-07/0260, issue 2013-06-26									
Anchor size	Ø8	Ø10	Ø12	Ø14	Ø16	Ø20	Ø25	Ø28	Ø32	
Non cracked concrete										
Tensile N_{Rk} BSt 500 S [kN]	28,0	42,4	58,3	70,6	70,6	111,9	153,7	224,0	262,4	
Shear V_{Rk} BSt 500 S [kN]	14,0	22,0	31,0	42,0	55,0	86,0	135,0	169,0	221,0	
Cracked concrete										
Tensile N_{Rk} BSt 500 S [kN]	16,1	22,6	31,1	38,5	44,0	74,8	109,6	154,4	181,0	
Shear V_{Rk} BSt 500 S [kN]	14,0	22,0	31,0	42,0	55,0	86,0	135,0	169,0	221,0	

Design resistance: concrete C 20/25 – $f_{ck,cube} = 25 \text{ N/mm}^2$, anchor rebar BSt 500 S

	Data according ETA-07/0260, issue 2013-06-26									
Anchor size	Ø8	Ø10	Ø12	Ø14	Ø16	Ø20	Ø25	Ø28	Ø32	
Non cracked concrete										
Tensile N_{Rd} BSt 500 S [kN]	16,8	23,6	32,4	39,2	33,6	53,3	73,2	106,7	125,0	
Shear V_{Rd} BSt 500 S [kN]	9,3	14,7	20,7	28,0	36,7	57,3	90,0	112,7	147,3	
Cracked concrete										
Tensile N_{Rd} BSt 500 S [kN]	8,9	12,6	17,3	21,4	20,9	35,6	52,2	73,5	86,2	
Shear V_{Rd} BSt 500 S [kN]	9,3	14,7	20,7	28,0	36,7	57,3	90,0	112,7	147,3	

Recommended loads ^{a)}: concrete C 20/25 – $f_{ck,cube} = 25 \text{ N/mm}^2$, anchor rebar BSt 500 S

		Data according ETA-07/0260, issue 2013-06-26									
Anchor size		Ø8	Ø10	Ø12	Ø14	Ø16	Ø20	Ø25	Ø28	Ø32	
Non cracked concrete											
Tensile N_{rec}	BSt 500 S [kN]	12,0	16,8	23,1	28,0	24,0	38,1	52,3	76,2	89,3	
Shear V_{rec}	BSt 500 S [kN]	6,7	10,5	14,8	20,0	26,2	41,0	64,3	80,5	105,2	
Cracked concrete											
Tensile N_{rec}	BSt 500 S [kN]	6,4	9,0	12,3	15,3	15,0	25,4	37,3	52,5	61,5	
Shear V_{rec}	BSt 500 S [kN]	6,7	10,5	14,8	20,0	26,2	41,0	64,3	80,5	105,2	

a) With overall partial safety factor for action $\gamma = 1,4$. The partial safety factors for action depend on the type of loading and shall be taken from national regulations.

Service temperature range

Hilti HIT-RE 500-SD injection mortar may be applied in the temperature ranges given below. An elevated base material temperature may lead to a reduction of the design bond resistance.

Temperature range	Base material temperature	Maximum long term base material temperature	Maximum short term base material temperature
Temperature range I	-40 °C to +40 °C	+24 °C	+40 °C
Temperature range II	-40 °C to +58 °C	+35 °C	+58 °C
Temperature range III	-40 °C to +70 °C	+43 °C	+70 °C

Max short term base material temperature

Short-term elevated base material temperatures are those that occur over brief intervals, e.g. as a result of diurnal cycling.

Max long term base material temperature

Long-term elevated base material temperatures are roughly constant over significant periods of time.

Materials

Mechanical properties of rebar BSt 500S

		Data according ETA-07/0260, issue 2013-06-26									
Anchor size		Ø8	Ø10	Ø12	Ø14	Ø16	Ø20	Ø25	Ø28	Ø32	
Nominal tensile strength f_{uk}	BSt 500 S [N/mm ²]	550	550	550	550	550	550	550	550	550	
Yield strength f_{yk}	BSt 500 S [N/mm ²]	500	500	500	500	500	500	500	500	500	
Stressed cross-section A_s	BSt 500 S [mm ²]	50,3	78,5	113,1	153,9	201,1	314,2	490,9	615,8	804,2	
Moment of resistance W	BSt 500 S [mm ³]	50,3	98,2	169,6	269,4	402,1	785,4	1534	2155	3217	

Material quality

Part	Material
rebar BSt 500 S	Geometry and mechanical properties according to DIN 488-2:1986 or E DIN 488-2:2006

Setting

installation equipment

Anchor size	Ø8	Ø10	Ø12	Ø14	Ø16	Ø20	Ø25	Ø28	Ø32
Rotary hammer	TE 2 – TE 16					TE 40 – TE 70			
Other tools	compressed air gun or blow out pump, set of cleaning brushes, dispenser								

Setting instruction

Bore hole drilling

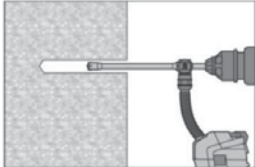
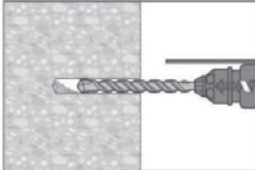
	<p>Drill hole to the required embedment depth with an appropriately sized Hilti TE-CD or TE-YD hollow drill bit with Hilti vacuum attachment. This drilling system removes the dust and cleans the borehole during drilling when using in accordance with the user's manual.</p> <p>After drilling is complete, proceed to the "injection preparation" step in the instructions for use.</p>
	<p>Drill Hole to the required embedment depth with a hammer drill set in rotation-hammer mode using an appropriately sized carbide drill bit.</p>

Bore hole cleaning Just before setting an anchor, the bore hole must be free of dust and debris.

Compressed air cleaning (CAC) for all bore hole diameters d_0 and all bore hole depth h_0

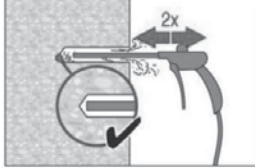
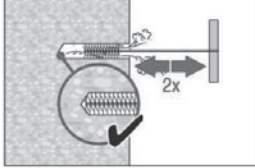
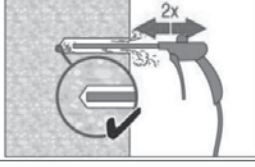
	<p>Blow 2 times from the back of the hole (if needed with nozzle extension) over the hole length with oil-free compressed air (min. 6 bar at 6 m³/h) until return air stream is free of noticeable dust.</p> <p>Bore hole diameter ≥ 32 mm the compressor must supply a minimum air flow of 140 m³/hour.</p>
	<p>Brush 2 times with the specified brush size by inserting the steel brush Hilti HIT-RB to the back of the hole (if needed with extension) in a twisting motion and removing it.</p> <p>The brush must produce natural resistance as it enters the bore hole -- if not the brush is too small and must be replaced with the proper brush diameter.</p>
	<p>Blow again with compressed air 2 times until return air stream is free of noticeable dust.</p>

Injection preparation

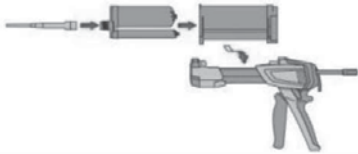

Tightly attach new Hilti mixing nozzle HIT-RE-M to foil pack manifold (snug fit). Do not modify the mixing nozzle.
Observe the instruction for use of the dispenser and the mortar. Check foil pack holder for proper function. Do not use damaged foil packs / holders. Insert foil pack into foil pack holder and put holder into HIT-dispenser.



The foil pack opens automatically as dispensing is initiated. Discard initial adhesive. Depending on the size of the foil pack an initial amount of adhesive has to be discarded.

Discard quantities are:

- 3 strokes for 330 ml foil pack,
- 4 strokes for 500 ml foil pack,
- 65 ml for 1400 ml foil pack $\leq 5^{\circ}\text{C}$.

Inject adhesive from the back of the borehole without forming air voids

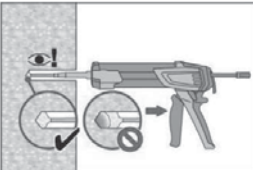

Inject the adhesive starting at the back of the hole, slowly withdrawing the mixer with each trigger pull.
Fill holes approximately 2/3 full. It is required that the annular gap between the anchor and the concrete is completely filled with adhesive along the embedment length.

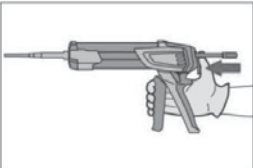

After injection is completed, depressurize the dispenser by pressing the release trigger. This will prevent further adhesive discharge from the mixer.

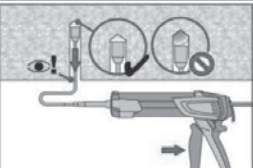

Overhead installation and/or installation with embedment depth $h_{ef} > 250\text{mm}$.

For overhead installation the injection is only possible with the aid of extensions and piston plugs. Assemble HIT-RE-M mixer, extension(s) and appropriately sized piston plug (HIT-SZ). Insert piston plug to back of the hole and inject adhesive. During injection the piston plug will be naturally extruded out of the bore hole by the adhesive pressure.

Setting the element

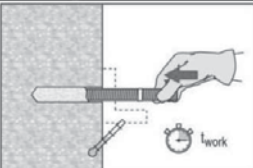

Before use, verify that the element is dry and free of oil and other contaminants.

Mark and set element to the required embedment depth until working time t_{work} has elapsed.

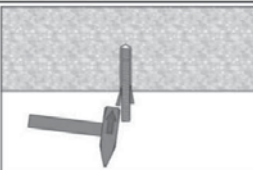

For overhead installation use piston plugs and fix embedded parts with e.g. wedges HIT-OHW.

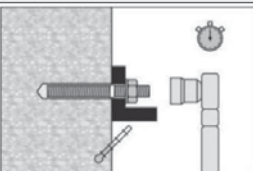

Loading the anchor:

After required curing time t_{cure} the anchor can be loaded.
The applied installation torque shall not exceed given T_{max} .

For detailed information on installation see instruction for use given with the package of the product.

Curing time for general conditions

Data according ETA-07/0260, issue 2013-06-26		
Temperature of the base material	Working time in which anchor can be inserted and adjusted t_{gel}	Curing time before anchor can be fully loaded t_{cure}
40 °C	12 min	4 h
30 °C to 39 °C	12 min	8 h
20 °C to 29 °C	20 min	12 h
15 °C to 19 °C	30 min	24 h
10 °C to 14 °C	90 min	48 h
5 °C to 9 °C	120 min	72 h

Setting details

		Data according ETA-07/0260, issue 2013-06-26								
Anchor size		Ø8	Ø10	Ø12	Ø14	Ø16	Ø20	Ø25	Ø28	Ø32
Nominal diameter of drill bit	d_0 [mm]	12	14	16	18	20	25	32	35	40
Effective anchorage and drill hole depth range ^{a)}	$h_{ef,min}$ [mm]	60	60	70	75	80	90	100	112	128
	$h_{ef,max}$ [mm]	160	200	240	280	320	400	500	560	640
Minimum base material thickness	h_{min} [mm]	$h_{ef} + 30 \text{ mm} \geq 100 \text{ mm}$			$h_{ef} + 2 d_0$					
Minimum spacing	s_{min} [mm]	40	50	60	70	80	100	125	140	160
Minimum edge distance	c_{min} [mm]	40	50	60	70	80	100	125	140	160
Critical spacing for splitting failure	$s_{cr,sp}$	$2 c_{cr,sp}$								
Critical edge distance for splitting failure ^{b)}	$c_{cr,sp}$ [mm]	$1,0 \cdot h_{ef}$ for $h / h_{ef} \geq 2,0$								
		$4,6 h_{ef} - 1,8 h$ for $2,0 > h / h_{ef} > 1,3$								
		$2,26 h_{ef}$ for $h / h_{ef} \leq 1,3$								
Critical spacing for concrete cone failure	$s_{cr,N}$	$2 c_{cr,N}$								
Critical edge distance for concrete cone failure ^{c)}	$c_{cr,N}$	$1,5 h_{ef}$								

For spacing (edge distance) smaller than critical spacing (critical edge distance) the design loads have to be reduced.

- a) $h_{ef,min} \leq h_{ef} \leq h_{ef,max}$ (h_{ef} : embedment depth)
- b) h : base material thickness ($h \geq h_{min}$)
- c) The critical edge distance for concrete cone failure depends on the embedment depth h_{ef} and the design bond resistance. The simplified formula given in this table is on the same side.

Simplified design method

Simplified version of the design method according ETAG 001, TR 029. Design resistance according data given in ETA-07/0260, issue 2009-01-12.

- Influence of concrete strength
- Influence of edge distance
- Influence of spacing
- Valid for a group of two anchors. (The method may also be applied for anchor groups with more than two anchors or more than one edge distance. The influencing factors must then be considered for each edge distance and spacing. The calculated design loads are then on the save side: They will be lower than the exact values according ETAG 001, TR 029. To avoid this, it is recommended to use the anchor design software PROFIS anchor)

The design method is based on the following simplification:

- No different loads are acting on individual anchors (no eccentricity)

The values are valid for one anchor.

For more complex fastening applications please use the anchor design software PROFIS Anchor.

Tension loading

The design tensile resistance is the lower value of

- Steel resistance: $N_{Rd,s}$
- Combined pull-out and concrete cone resistance:
 $N_{Rd,p} = N_{Rd,p}^0 \cdot f_{B,p} \cdot f_{1,N} \cdot f_{2,N} \cdot f_{3,N} \cdot f_{h,p} \cdot f_{re,N}$
- Concrete cone resistance: $N_{Rd,c} = N_{Rd,c}^0 \cdot f_B \cdot f_{1,N} \cdot f_{2,N} \cdot f_{3,N} \cdot f_{h,N} \cdot f_{re,N}$
- Concrete splitting resistance (only non-cracked concrete):
 $N_{Rd,sp} = N_{Rd,c}^0 \cdot f_B \cdot f_{1,sp} \cdot f_{2,sp} \cdot f_{3,sp} \cdot f_{h,N}$

$f_{re,N}$

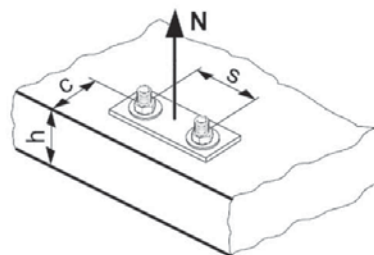

Basic design tensile resistance

Design steel resistance $N_{Rd,s}$

			Data according ETA-07/0260, issue 2013-06-26								
Anchor size			Ø8	Ø10	Ø12	Ø14	Ø16	Ø20	Ø25	Ø28	Ø32
$N_{Rd,s}$	BSt 500 S	[kN]	20,0	30,7	44,3	60,7	79,3	123,6	192,9	242,1	315,7

Design combined pull-out and concrete cone resistance

$$N_{Rd,p} = N_{Rd,p}^0 \cdot f_{B,p} \cdot f_{1,N} \cdot f_{2,N} \cdot f_{3,N} \cdot f_{h,p} \cdot f_{re,N}$$

		Data according ETA-07/0260, issue 2013-06-26								
Anchor size		Ø8	Ø10	Ø12	Ø14	Ø16	Ø20	Ø25	Ø28	Ø32
Typical embedment depth $h_{ef,typ}$ [mm]		80	90	110	125	125	170	210	270	300
Non cracked concrete										
$N_{Rd,p}^0$ Temperature range I [kN]		16,8	23,6	34,6	42,8	41,9	71,2	102,1	147,0	186,7
$N_{Rd,p}^0$ Temperature range II [kN]		13,4	18,8	27,6	36,7	32,9	56,0	86,4	113,1	143,6
$N_{Rd,p}^0$ Temperature range III [kN]		7,8	11,0	16,1	21,4	20,9	33,1	51,1	67,9	86,2
Cracked concrete										
$N_{Rd,p}^0$ Temperature range I [kN]		8,9	12,6	17,3	21,4	20,9	35,6	55,0	73,5	86,2
$N_{Rd,p}^0$ Temperature range II [kN]		7,3	10,2	13,8	18,3	18,0	28,0	43,2	56,5	71,8
$N_{Rd,p}^0$ Temperature range III [kN]		4,5	5,5	8,1	10,7	10,5	15,3	23,6	33,9	43,1

Design concrete cone resistance $N_{Rd,c} = N_{Rd,c}^0 \cdot f_B \cdot f_{1,N} \cdot f_{2,N} \cdot f_{3,N} \cdot f_{h,N} \cdot f_{re,N}$

Design splitting resistance ^{a)} $N_{Rd,sp} = N_{Rd,c}^0 \cdot f_B \cdot f_{1,sp} \cdot f_{2,sp} \cdot f_{3,sp} \cdot f_{h,N} \cdot f_{re,N}$

		Data according ETA-07/0260, issue 2013-06-26								
Anchor size		Ø8	Ø10	Ø12	Ø14	Ø16	Ø20	Ø25	Ø28	Ø32
$N_{Rd,c}^0$ Non cracked concrete [kN]		20,1	24,0	32,4	39,2	33,6	53,3	73,2	106,7	125,0
$N_{Rd,c}^0$ Cracked concrete [kN]		14,3	17,1	23,1	28,0	24,0	38,0	52,2	76,1	89,1

a) Splitting resistance must only be considered for non-cracked concrete

Influencing factors
Influence of concrete strength on combined pull-out and concrete cone resistance

Concrete strength designation (ENV 206)	C 20/25	C 25/30	C 30/37	C 35/45	C 40/50	C 45/55	C 50/60
$f_{B,p} = (f_{ck,cube}/25N/mm^2)^{0,1}$ ^{a)}	1	1,02	1,04	1,06	1,07	1,08	1,09

a) $f_{ck,cube}$ = concrete compressive strength, measured on cubes with 150 mm side length

Influence of embedment depth on combined pull-out and concrete cone resistance

$$f_{h,p} = h_{ef}/h_{ef,typ}$$

Influence of concrete strength on concrete cone resistance

Concrete strength designation (ENV 206)	C 20/25	C 25/30	C 30/37	C 35/45	C 40/50	C 45/55	C 50/60
$f_B = (f_{ck,cube}/25N/mm^2)^{1/2}$ ^{a)}	1	1,1	1,22	1,34	1,41	1,48	1,55

a) $f_{ck,cube}$ = concrete compressive strength, measured on cubes with 150 mm side length

Influence of edge distance ^{a)}

$c/c_{cr,N}$	0,1	0,2	0,3	0,4	0,5	0,6	0,7	0,8	0,9	1
$c/c_{cr,sp}$										
$f_{1,N} = 0,7 + 0,3 \cdot c/c_{cr,N}$	0,73	0,76	0,79	0,82	0,85	0,88	0,91	0,94	0,97	1
$f_{1,sp} = 0,7 + 0,3 \cdot c/c_{cr,sp}$										
$f_{2,N} = 0,5 \cdot (1 + c/c_{cr,N})$	0,55	0,60	0,65	0,70	0,75	0,80	0,85	0,90	0,95	1
$f_{2,sp} = 0,5 \cdot (1 + c/c_{cr,sp})$										

a) The edge distance shall not be smaller than the minimum edge distance c_{min} given in the table with the setting details. These influencing factors must be considered for every edge distance smaller than the critical edge distance.

Influence of anchor spacing ^{a)}

$s/s_{cr,N}$	0,1	0,2	0,3	0,4	0,5	0,6	0,7	0,8	0,9	1
$s/s_{cr,sp}$										
$f_{3,N} = 0,5 \cdot (1 + s/s_{cr,N})$	0,55	0,60	0,65	0,70	0,75	0,80	0,85	0,90	0,95	1
$f_{3,sp} = 0,5 \cdot (1 + s/s_{cr,sp})$										

a) The anchor spacing shall not be smaller than the minimum anchor spacing s_{min} given in the table with the setting details. This influencing factor must be considered for every anchor spacing.

Influence of embedment depth on concrete cone resistance

$$f_{h,N} = (h_{ef}/h_{ef,typ})^{1,5}$$

Influence of reinforcement

h_{ef} [mm]	40	50	60	70	80	90	≥ 100
$f_{re,N} = 0,5 + h_{ef}/200mm \leq 1$	0,7 ^{a)}	0,75 ^{a)}	0,8 ^{a)}	0,85 ^{a)}	0,9 ^{a)}	0,95 ^{a)}	1

a) This factor applies only for dense reinforcement. If in the area of anchorage there is reinforcement with a spacing ≥ 150 mm (any diameter) or with a diameter ≤ 10 mm and a spacing ≥ 100 mm, then a factor $f_{re} = 1$ may be applied.

Shear loading

The design shear resistance is the lower value of

- Steel resistance: $V_{Rd,s}$
- Concrete pryout resistance: $V_{Rd,cp} = k \cdot \text{lower value of } N_{Rd,p} \text{ and } N_{Rd,c}$
- Concrete edge resistance: $V_{Rd,c} = V_{Rd,c}^0 \cdot f_B \cdot f_h \cdot f_4 \cdot f_{hef} \cdot f_c$

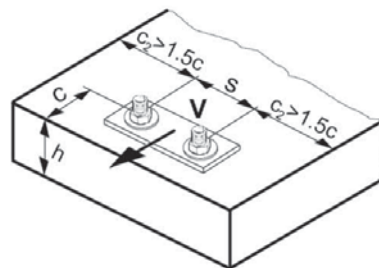

Basic design shear resistance

Design steel resistance $V_{Rd,s}$

		Data according ETA-07/0260, issue 2013-06-26								
Anchor size		Ø8	Ø10	Ø12	Ø14	Ø16	Ø20	Ø25	Ø28	Ø32
$V_{Rd,s}$	BSt 500 S [kN]	9,3	14,7	20,7	28,0	36,7	57,3	90,0	112,7	147,3

Design concrete pryout resistance $V_{Rd,cp} = \text{lower value}^a$ of $k \cdot N_{Rd,p}$ and $k \cdot N_{Rd,c}$

$$k = 1 \text{ for } h_{ef} < 60 \text{ mm}$$

$$k = 2 \text{ for } h_{ef} \geq 60 \text{ mm}$$

- a) $N_{Rd,p}$: Design combined pull-out and concrete cone resistance
 $N_{Rd,c}$: Design concrete cone resistance

Design concrete edge resistance $V_{Rd,c} = V_{Rd,c}^0 \cdot f_B \cdot f_\beta \cdot f_h \cdot f_4 \cdot f_{hef} \cdot f_c$

		Data according ETA-07/0260, issue 2013-06-26								
Anchor size		Ø8	Ø10	Ø12	Ø14	Ø16	Ø20	Ø25	Ø28	Ø32
Non-cracked concrete										
$V_{Rd,c}^0$	[kN]	5,9	8,6	11,6	15,0	18,7	27,0	39,2	47,3	59,0
Cracked concrete										
$V_{Rd,c}^0$	[kN]	4,2	6,1	8,2	10,6	13,2	19,2	27,7	33,5	41,8

Influencing factors

Influence of concrete strength

Concrete strength designation (ENV 206)	C 20/25	C 25/30	C 30/37	C 35/45	C 40/50	C 45/55	C 50/60
$f_B = (f_{ck,cube}/25\text{N/mm}^2)^{1/2}$ a)	1	1,1	1,22	1,34	1,41	1,48	1,55

- a) $f_{ck,cube}$ = concrete compressive strength, measured on cubes with 150 mm side length

Influence of angle between load applied and the direction perpendicular to the free edge

Angle β	0°	10°	20°	30°	40°	50°	60°	70°	80°	≥ 90°
$f_\beta = \frac{1}{\sqrt{(\cos \alpha_r)^2 + \left(\frac{\sin \alpha_r}{2,5}\right)^2}}$ 	1	1,01	1,05	1,13	1,24	1,40	1,64	1,97	2,32	2,50

Influence of base material thickness

h/c	0,15	0,3	0,45	0,6	0,75	0,9	1,05	1,2	1,35	≥ 1,5
$f_h = \{h/(1,5 \cdot c)\}^{1/2} \leq 1$	0,32	0,45	0,55	0,63	0,71	0,77	0,84	0,89	0,95	1,00

Influence of anchor spacing and edge distance ^{a)} for concrete edge resistance: f_4
 $f_4 = (c/h_{ef})^{1,5} \cdot (1 + s / [3 \cdot c]) \cdot 0,5$

c/h _{ef}	Single anchor	Group of two anchors s/h _{ef}														
		0,75	1,50	2,25	3,00	3,75	4,50	5,25	6,00	6,75	7,50	8,25	9,00	9,75	10,50	11,25
0,50	0,35	0,27	0,35	0,35	0,35	0,35	0,35	0,35	0,35	0,35	0,35	0,35	0,35	0,35	0,35	0,35
0,75	0,65	0,43	0,54	0,65	0,65	0,65	0,65	0,65	0,65	0,65	0,65	0,65	0,65	0,65	0,65	0,65
1,00	1,00	0,63	0,75	0,88	1,00	1,00	1,00	1,00	1,00	1,00	1,00	1,00	1,00	1,00	1,00	1,00
1,25	1,40	0,84	0,98	1,12	1,26	1,40	1,40	1,40	1,40	1,40	1,40	1,40	1,40	1,40	1,40	1,40
1,50	1,84	1,07	1,22	1,38	1,53	1,68	1,84	1,84	1,84	1,84	1,84	1,84	1,84	1,84	1,84	1,84
1,75	2,32	1,32	1,49	1,65	1,82	1,98	2,15	2,32	2,32	2,32	2,32	2,32	2,32	2,32	2,32	2,32
2,00	2,83	1,59	1,77	1,94	2,12	2,30	2,47	2,65	2,83	2,83	2,83	2,83	2,83	2,83	2,83	2,83
2,25	3,38	1,88	2,06	2,25	2,44	2,63	2,81	3,00	3,19	3,38	3,38	3,38	3,38	3,38	3,38	3,38
2,50	3,95	2,17	2,37	2,57	2,77	2,96	3,16	3,36	3,56	3,76	3,95	3,95	3,95	3,95	3,95	3,95
2,75	4,56	2,49	2,69	2,90	3,11	3,32	3,52	3,73	3,94	4,15	4,35	4,56	4,56	4,56	4,56	4,56
3,00	5,20	2,81	3,03	3,25	3,46	3,68	3,90	4,11	4,33	4,55	4,76	4,98	5,20	5,20	5,20	5,20
3,25	5,86	3,15	3,38	3,61	3,83	4,06	4,28	4,51	4,73	4,96	5,18	5,41	5,63	5,86	5,86	5,86
3,50	6,55	3,51	3,74	3,98	4,21	4,44	4,68	4,91	5,14	5,38	5,61	5,85	6,08	6,31	6,55	6,55
3,75	7,26	3,87	4,12	4,36	4,60	4,84	5,08	5,33	5,57	5,81	6,05	6,29	6,54	6,78	7,02	7,26
4,00	8,00	4,25	4,50	4,75	5,00	5,25	5,50	5,75	6,00	6,25	6,50	6,75	7,00	7,25	7,50	7,75
4,25	8,76	4,64	4,90	5,15	5,41	5,67	5,93	6,18	6,44	6,70	6,96	7,22	7,47	7,73	7,99	8,25
4,50	9,55	5,04	5,30	5,57	5,83	6,10	6,36	6,63	6,89	7,16	7,42	7,69	7,95	8,22	8,49	8,75
4,75	10,35	5,45	5,72	5,99	6,27	6,54	6,81	7,08	7,36	7,63	7,90	8,17	8,45	8,72	8,99	9,26
5,00	11,18	5,87	6,15	6,43	6,71	6,99	7,27	7,55	7,83	8,11	8,39	8,66	8,94	9,22	9,50	9,78
5,25	12,03	6,30	6,59	6,87	7,16	7,45	7,73	8,02	8,31	8,59	8,88	9,17	9,45	9,74	10,02	10,31
5,50	12,90	6,74	7,04	7,33	7,62	7,92	8,21	8,50	8,79	9,09	9,38	9,67	9,97	10,26	10,55	10,85

a) The anchor spacing and the edge distance shall not be smaller than the minimum anchor spacing s_{min} and the minimum edge distance c_{min} .

Influence of embedment depth

h _{ef} /d	4	4,5	5	6	7	8	9	10	11
$f_{hef} = 0,05 \cdot (h_{ef} / d)^{1,68}$	0,51	0,63	0,75	1,01	1,31	1,64	2,00	2,39	2,81
h _{ef} /d	12	13	14	15	16	17	18	19	20
$f_{hef} = 0,05 \cdot (h_{ef} / d)^{1,68}$	3,25	3,72	4,21	4,73	5,27	5,84	6,42	7,04	7,67

Influence of edge distance ^{a)}

c/d	4	6	8	10	15	20	30	40
$f_c = (d / c)^{0,19}$	0,77	0,71	0,67	0,65	0,60	0,57	0,52	0,50

a) The edge distance shall not be smaller than the minimum edge distance c_{min} .

Combined tension and shear loading

For combined tension and shear loading see section "Anchor Design".

Seismic design C1

Basic loading data for concrete C20/25 – C50/60

All data in this section applies to:

- Seismic design according to TR045

The following technical data are based on: ETA-07/0260, issue 2013-06-26

Anchorage depth range

Anchor size		Φ8	Φ10	Φ12	Φ14	Φ16	Φ20	Φ25	Φ26	Φ28	Φ30	Φ32
Effective anchorage	$h_{ef,min}$ [mm]	60	60	70	80	80	90	100	104	115	120	130
depth range	$h_{ef,max}$ [mm]	160	200	240	280	320	400	500	520	540	600	660

Tension resistance in case of seismic performance category C1

Anchor size		Φ8	Φ10	Φ12	Φ14	Φ16	Φ20	Φ25	Φ26	Φ28	Φ30	Φ32	
Characteristic tension resistance to steel failure													
Rebar B500B Acc. to DIN 488:2009-08	$N_{Rk,s,seis}$ [kN]	28	43	62	85	111	173	270	-	339	-	442	
Partial safety factor Acc. to DIN 488:2009-08	$\gamma_{Ms,seis}$ [-]	1,4						-		1,4		1,4	
Characteristic bond resistance in cracked concrete C20/25 to C50/60													
Temp. range I: 40°C/24°C	$\tau_{Rk,seis}$ [N/mm ²]	6,4	6,4	6	5,4	5,3	5	4,6	4,5	4	3,6	3,4	
Temp. range II: 58°C/35°C	$\tau_{Rk,seis}$ [N/mm ²]	5,2	5,2	4,8	4,7	4,5	3,9	3,6	3,5	3,1	3,0	2,9	
Temp. range III: 70°C/43°C	$\tau_{Rk,seis}$ [N/mm ²]	3,2	2,8	2,8	2,7	2,6	2,1	2	1,9	1,8	1,8	1,7	
Partial safety factor	$\gamma_{Mp,seis}$ [-]	1,8					2,1						
Concrete cone resistance and splitting resistance													
Partial safety factor	$\gamma_{Mc,seis} = \gamma_{Msp,seis}$ [-]	1,8					2,1						

Displacement under tension load in case of seismic performance category C1 ¹⁾

Anchor size		Φ8	Φ10	Φ12	Φ14	Φ16	Φ20	Φ25	Φ26	Φ28	Φ30	Φ32
Displacement ¹⁾	$\delta_{N,seis}$ [mm]	1,5	1,7	1,9	2,1	2,3	2,7	3,2	3,3	3,5	3,7	3,9

1) Maximum displacement during cycling (seismic event).

Shear resistance in case of seismic performance category C1

Anchor size		Φ8	Φ10	Φ12	Φ14	Φ16	Φ20	Φ25	Φ26	Φ28	Φ30	Φ32	
Characteristic shear resistance to steel failure													
Rebar B500B Acc. to DIN 488:2009-08	$N_{Rk,s,seis}$ [kN]	10	15	22	29	39	60	95	-	118	-	155	
Partial safety factor Acc. to DIN 488:2009-08	$\gamma_{Ms,seis}$ [-]	1,5						-		1,5		1,5	
Concrete pryout resistance and concrete edge resistance													
Partial safety factor	$\gamma_{Mcp,seis} = \gamma_{Mc,seis}$ [-]	1,5											

Displacement under shear load in case of seismic performance category C1 ¹⁾

Anchor size	Φ8	Φ10	Φ12	Φ14	Φ16	Φ20	Φ25	Φ26	Φ28	Φ30	Φ32
Displacement ¹⁾ $\delta_{v,seis}$ [mm]	3,2	3,5	3,8	4,1	4,4	5,0	5,8	5,9	6,2	6,5	6,8

1) Maximum displacement during cycling (seismic event).

For seismic resistant fastening applications please use the anchor design software PROFIS Anchor.